

# Ice House Product Offering

## About us

At Ice House we are an established name in the UK Cold room industry. Our management team has over 30 years' experience in successfully delivering cold room solutions, to both Corporate and Private clients. We are renowned for our reliability, expertise and quality of service. We do not sub contract our work to third parties, but use our own highly trained, qualified and experienced work force.

## Mission statement

To set the Standard for Service in the Cold room industry.

## Who are our clients

We provide Cold rooms to both the Public and Private sector. Cold rooms come in two forms, chillers and freezers, sizes vary from giant rooms that enable hospitals and prisons to upgrade their facilities to smaller rooms perfect for catering for weddings or parties.

At Ice House, we are the main contractor for cold rooms to some of the country's largest retailers, enabling them to re fit stores and meet surges in demand at Christmas. We offer short, medium and long term hire across the United Kingdom and Europe. This includes installation, technical support and maintenance. On site engineering support is also available.

## What makes us different

At Ice House, we use Viessmann Cold rooms. These are modular cold rooms which enables us to access sites that may otherwise be hard to reach. All rooms come with internal lighting, plastic strip curtains for inside doors (essential for good EHO practice/HACCP) and lockable doors.

If you have a Cold store requirement and want us to help you find a solution, please give us a call, we would be happy to help.

## We offer Cold rooms for

- Internal and external use.
- In a wide variety of sizes and configurations

## Sizes & Specs of Cold Rooms

TSS	METRES	FEET	SQ /Ft	NO OF MOTORS	POWER TYPE	PLUG TYPE	TEMP RANGE
CHILL/FREEZE	1.8M X 1.8M	6 X 6	36	1	16 AMP	Single phase commando per motor	(-18c) - (+4c)
CHILL/FREEZE	1.8M X 2.4M	6 X 8	48	1	16 AMP	Single phase commando per motor	(-18c) - (+4c)
CHILL/FREEZE	1.8M X 3.6M	6 X 12	72	1	16 AMP	Single phase commando per motor	(-18c) - (+4c)
CHILL/FREEZE	1.8M X 4.8M	6 X 16	96	1	16 AMP	Single phase commando per motor	(-18c) - (+4c)
CHILL/FREEZE	2.4M X 2.4M	8 X 8	64	1	16 AMP	Single phase commando per motor	(-18c) - (+4c)
CHILL/FREEZE	2.4M X 3.6M	8 X 12	96	1	16 AMP	Single phase commando per motor	(-18c) - (+4c)
CHILL/FREEZE	2.4M X 4.8M	8 X 16	128	2	16 AMP	Single phase commando per motor	(-18c) - (+4c)
CHILL/FREEZE	2.4M X 6.0M	8 X 20	160	2	16 AMP	Single phase commando per motor	(-18c) - (+4c)
CHILL/FREEZE	2.4M x 7.2M	8 x 24	192	3	16 AMP	Single phase commando per motor	(-18c) - (+4c)
CHILL/FREEZE	2.4M x 8.4 M	8 x 28	224	3	16 AMP	Single phase commando per motor	(-18c) - (+4c)
CHILL/FREEZE	2.4M x 9.6 M	8 x 32	256	3	16 AMP	Single phase commando per motor	(-18c) - (+4c)
CHILL/FREEZE	4.8M X 2.4M	16 X 8	128	2	16 AMP	Single phase commando per motor	(-18c) - (+4c)
CHILL/FREEZE	4.8M X 3.6M	16 X 12	192	3	16 AMP	Single phase commando per motor	(-18c) - (+4c)
CHILL/FREEZE	4.8M X 4.8M	16 X 16	256	3	16 AMP	Single phase commando per motor	(-18c) - (+4c)
CHILL/FREEZE	4.8M X 6.0M	16 X 20	320	4	16 AMP	Single phase commando per motor	(-18c) - (+4c)
CHILL/FREEZE	4.8M X 7.2M	16 X 24	384	4	16 AMP	Single phase commando per motor	(-18c) - (+4c)

## MODULAR COLD ROOMS

Sizes & specifications

### 1.8m VARIATIONS

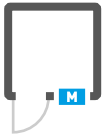

1.8m x 1.8m (6ft x 6ft)



1.8m x 2.4m (6ft x 8ft)



1.8m x 3.6m (6ft x 12ft)



1.8m x 4.8m (6ft x 16ft)

### 2.4m VARIATIONS

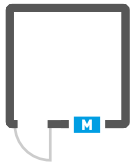

2.4m x 2.4m (8ft x 8ft)



2.4m x 3.6m (8ft x 12ft)

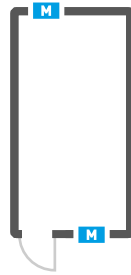

2.4m x 4.8m (8ft x 18ft)

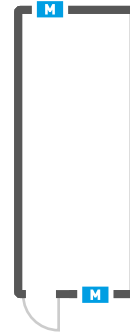

2.4m x 6m (8ft x 20ft)

### 4.8m VARIATIONS

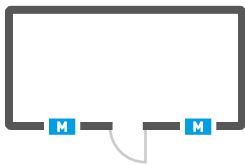

4.8m x 2.4m (16ft x 8ft)

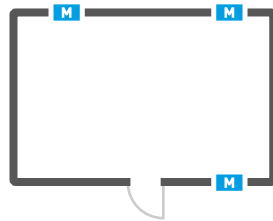

4.8m x 3.6m (16ft x 12ft)

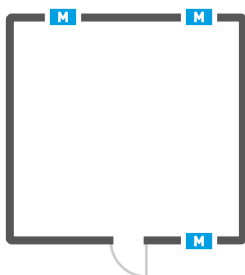

4.8m x 4.8m (16ft x 16ft)

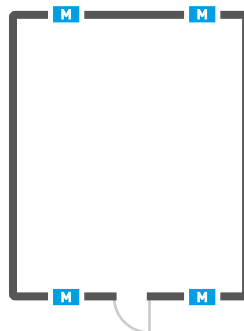

4.8m x 6m (16ft x 20ft)

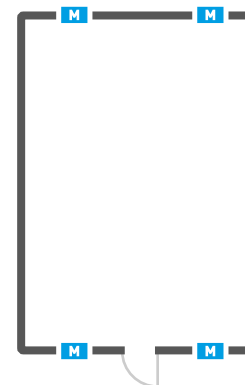

4.8m x 7.2m (16ft x 28ft)

---

# All you need to do is **let us know:**

- What size room you would like?
- Chiller or Freezer?
- What additional products/features you would like?

## **You will need:**

- Single phase 16amp power supply
- Ensure you allow for a 1 metre clearance around any motor or door
- Level ground to build the cold room

## **Additional Products/Features available**

- Shelving
- Ramp
- Doors to enable pallet access
- More than one access door
- Electrical leads
- Python Access Points

As part of the **WDT group** we also offer an array of all standalone fridge and freezer solutions from ice cream servers to over the counter servers.